

THE INTERNATIONAL SCHOOL

Classroom layout: Stearns Hall

Mailing address:

025 SW Sherman Street, Portland, OR 97201

Physical address:

2305 SW Water Avenue, Portland, OR 97201

CARUTHERS STREET

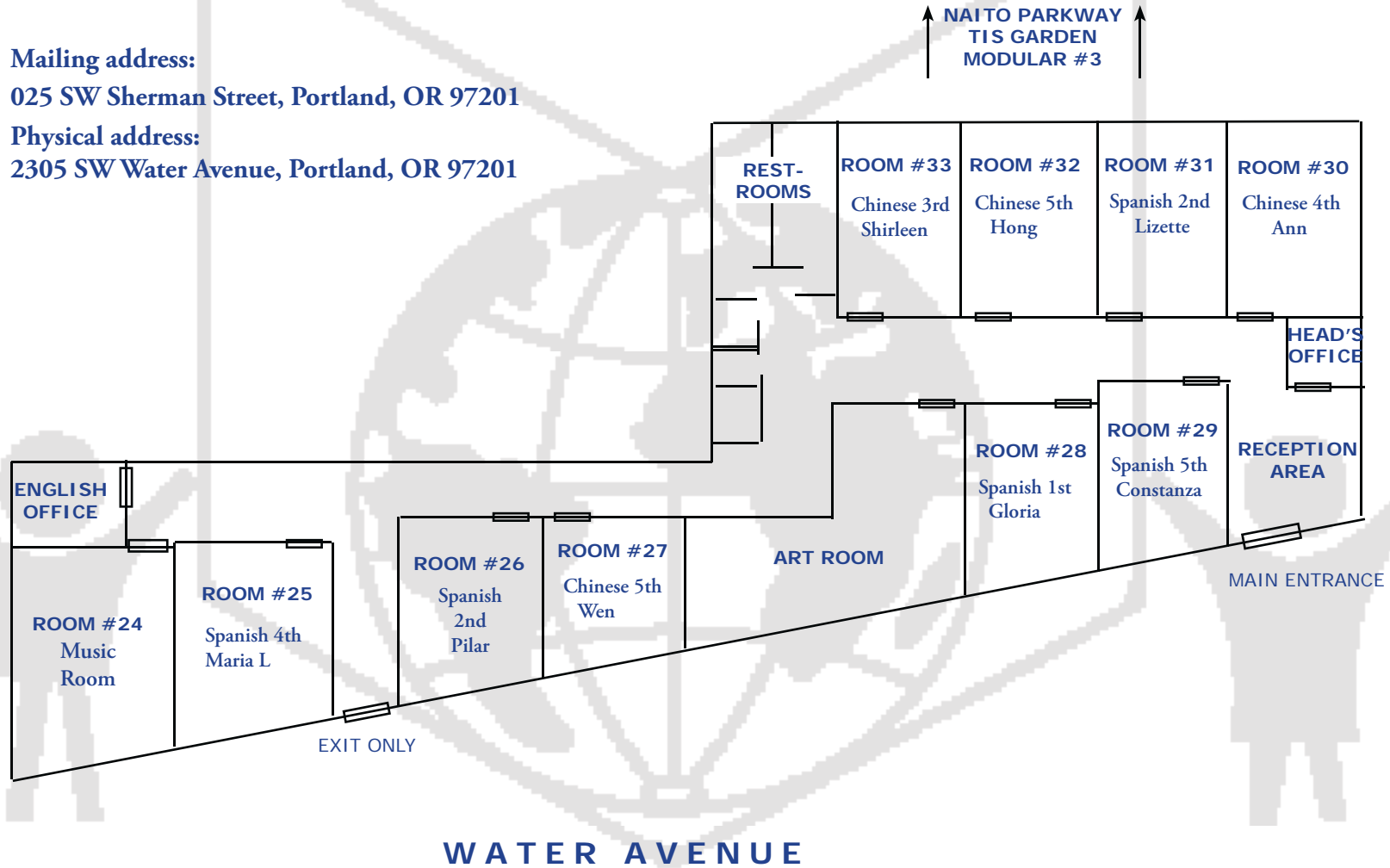

THE INTERNATIONAL SCHOOL

Classroom layout: modular buildings

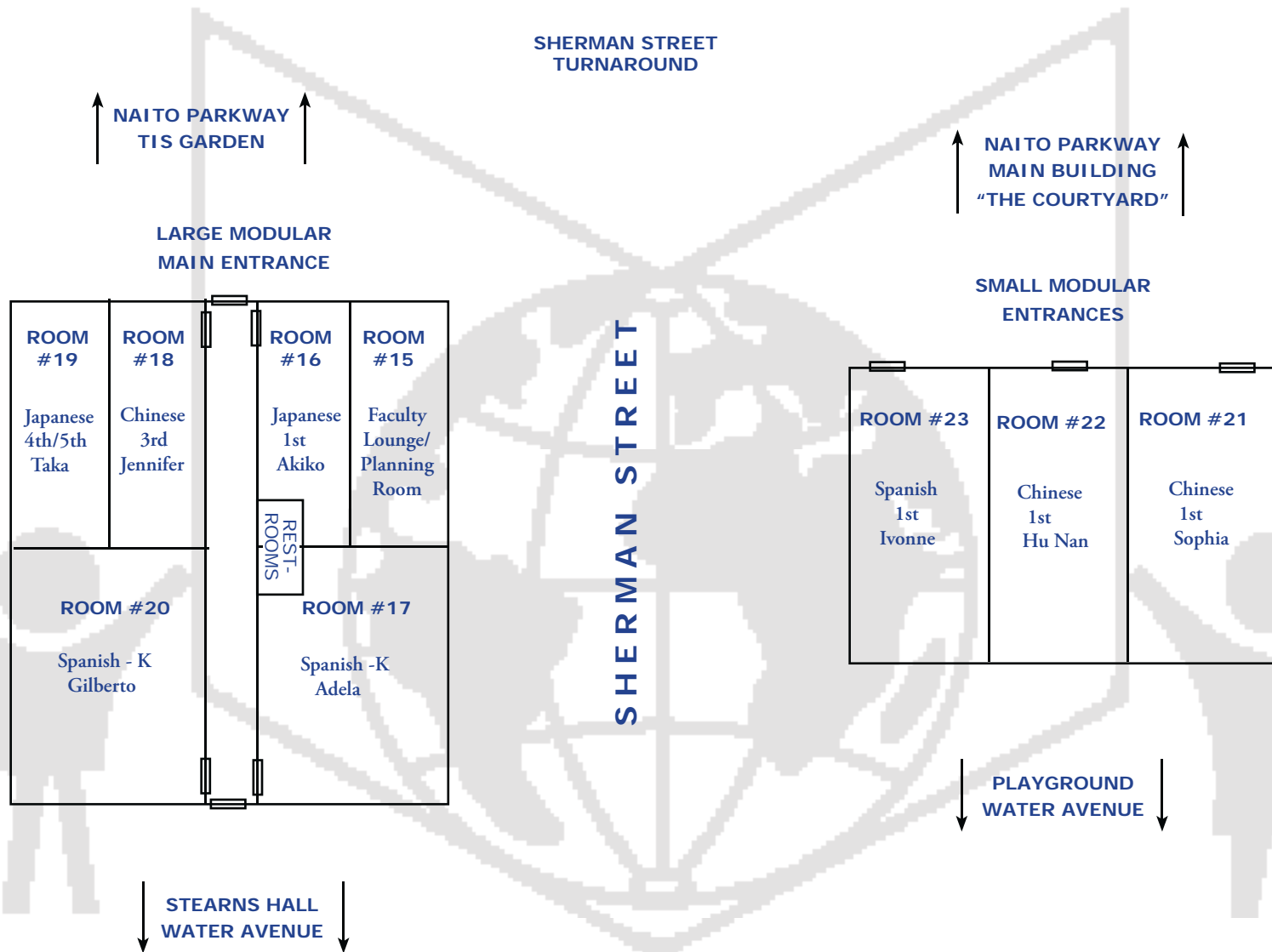

THE INTERNATIONAL SCHOOL

Classroom layout: Hilltop Building, bottom & middle floors

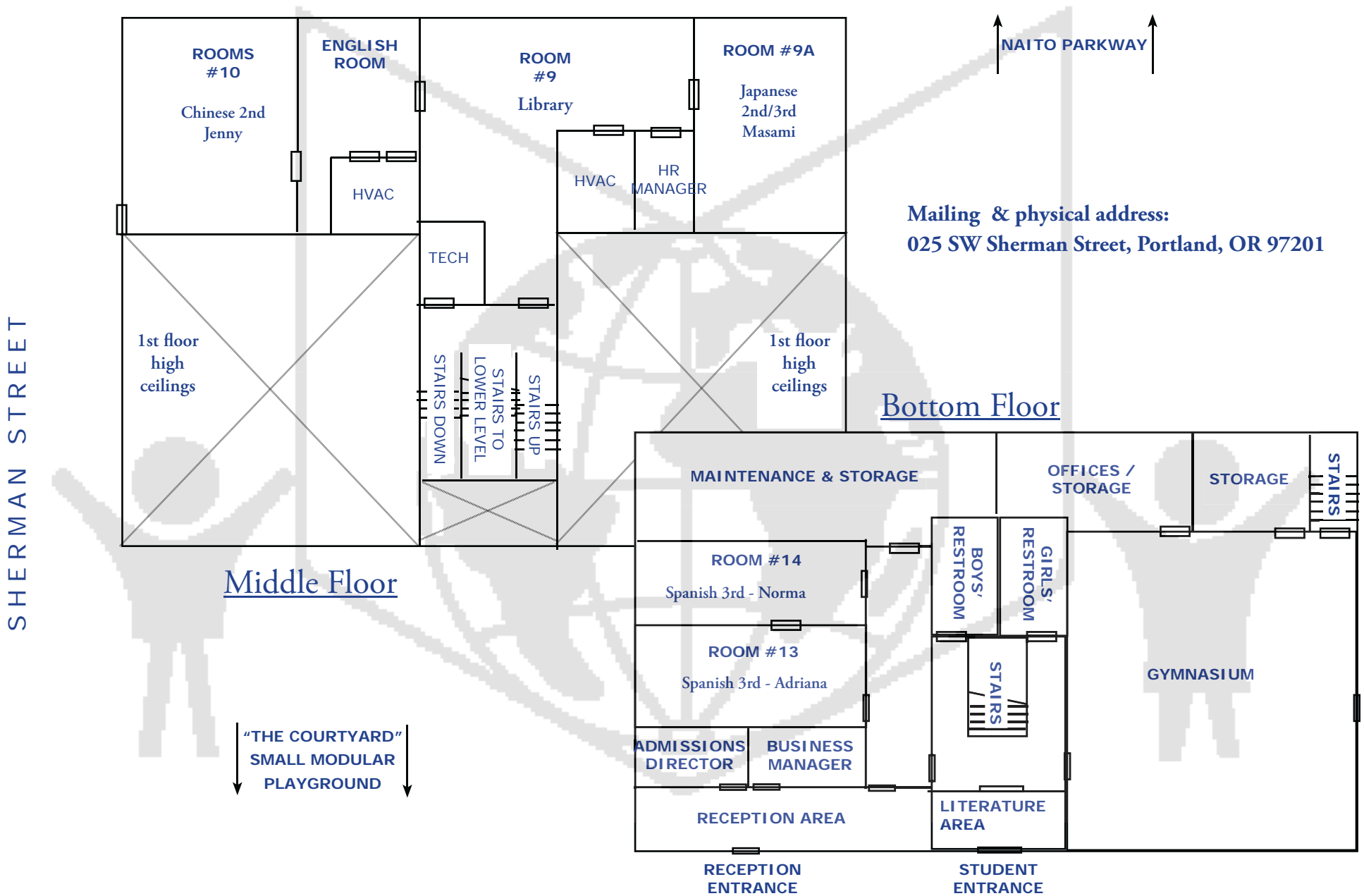

THE INTERNATIONAL SCHOOL

Classroom layout: Hilltop Building, top floor

Top Floor

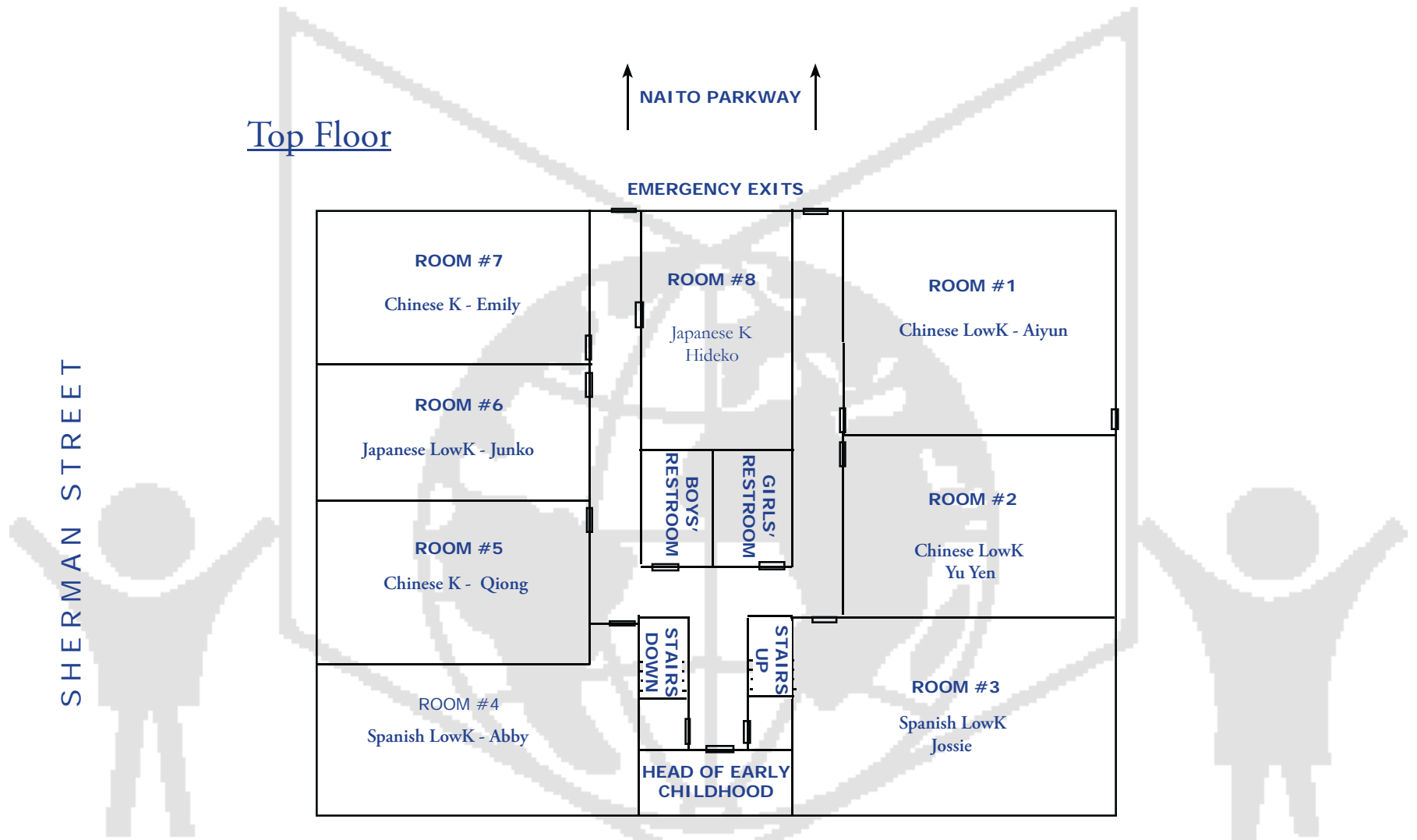

SHERMAN STREET

↑ NAITO PARKWAY ↑

EMERGENCY EXITS

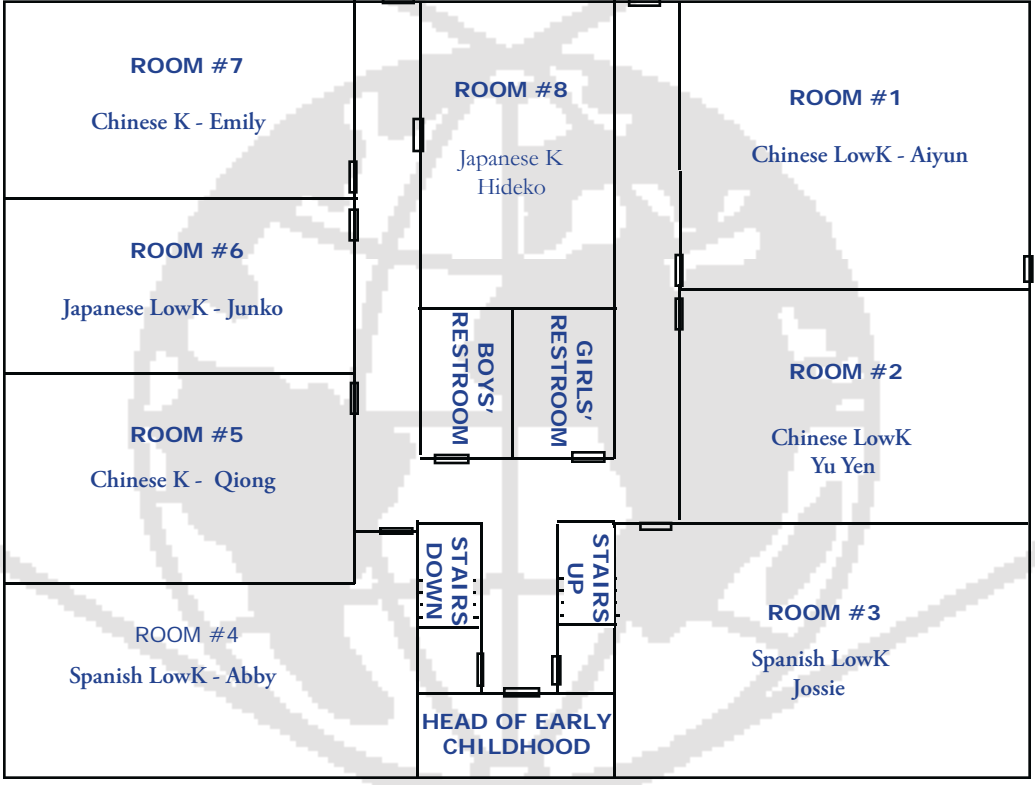

↓ "THE COURTYARD"
MODULAR #2
PLAYGROUND ↓

Mailing & physical address:
025 SW Sherman Street, Portland, OR 97201

THE INTERNATIONAL SCHOOL

Classroom layout: Arthur Street Campus

All PreK (3 year old) classrooms

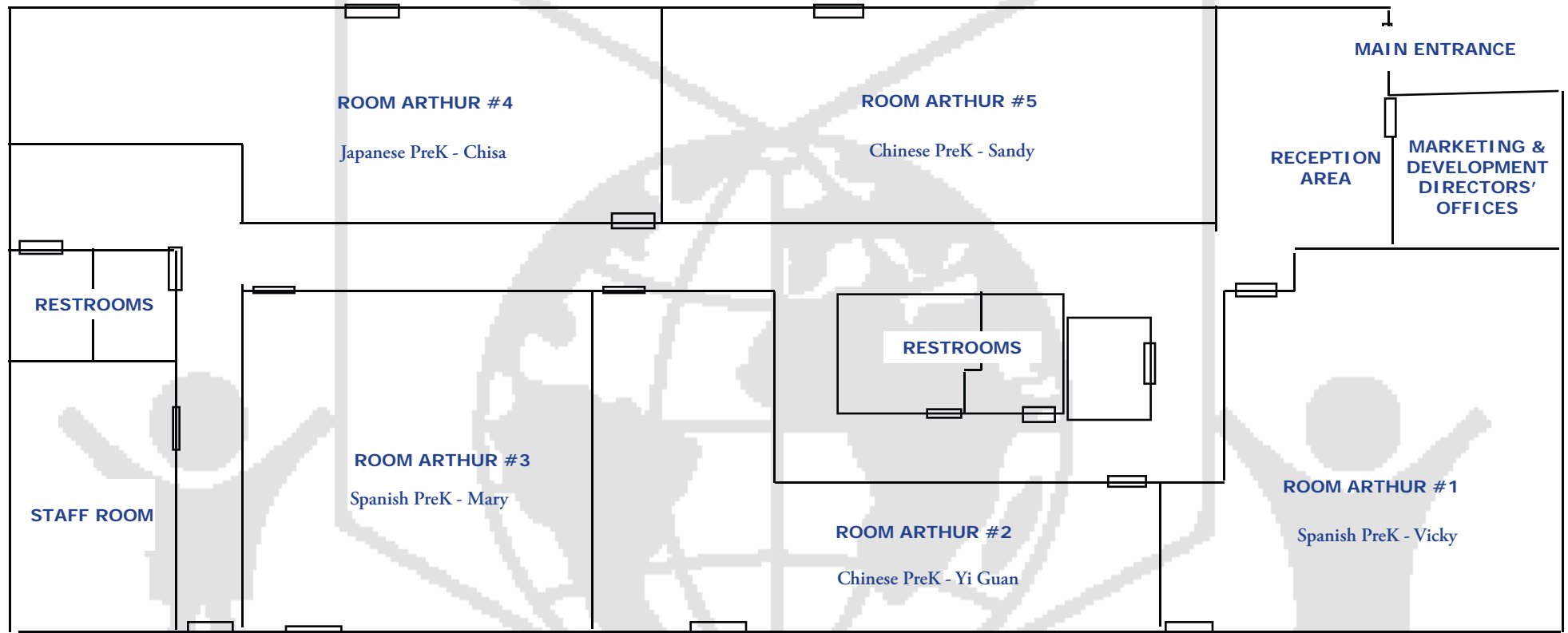

ARTHUR STREET

Mailing address:
025 SW Sherman Street, Portland, OR 97201

Physical address:
0122 SW Arthur Street, Portland, OR 97201